

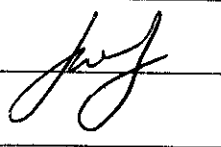

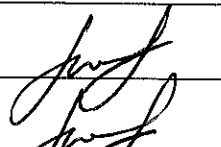
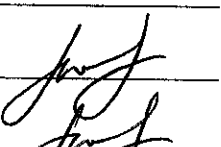
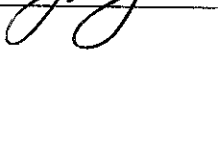

**Drain:** WILSON-NAGLE **Drain #:** 175  
**Improvement/Arm:** TOWN OF ARCADIA BYPASS  
**Operator:** J. LIVINGSTON **Date:** 9-9-04  
**Drain Classification:** Urban/Rural **Year Installed:** 1966

**GIS Drain Input Checklist**

- Pull Source Documents for Scanning 
- Digitize & Attribute Tile Drains 
- Digitize & Attribute Storm Drains 
- Digitize & Attribute SSD 
- Digitize & Attribute Open Ditch 
- Stamp Plans 
- Sum drain lengths & Validate 
- Enter Improvements into Posse 
- Enter Drain Age into Posse 
- Sum drain length for Watershed in Posse 
- Check Database entries for errors 

**Gasb 34 Footages for Historical Cost  
Drain Length Log**

Drain-Improvement: WILSON NAGLE - TOWN OF ARCADIA BYPASS

Drain Type:	Size:	Length PLANS	Length (DB Query)	Length Reconcile	If Applicable	
					Price:	Cost:
RCP (Wm Wilson)	15"	1168'	1091'	-77'	9. <sup>50</sup> / <sub>11</sub>	10,364. <sup>50</sup>
(GUY BOOTH)	30"	1592'	1604	+12'	24. <sup>60</sup> / <sub>11</sub>	39,458. <sup>40</sup>

Sum:                      2760'      2695'      -65'                      \$49,822.<sup>90</sup>

Final Report: \_\_\_\_\_

Comments:

LENGTHS MEASURED IN GIS: BASED ON STRUCTURE LOCATIONS  
PROVIDED BY STEVE BAITZ FROM FIELD VERIFICATION PERFORMED  
9-8-2004.

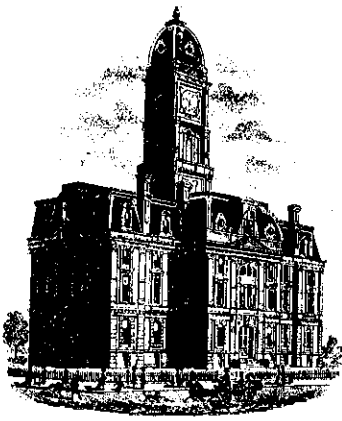

SURVEYOR'S OFFICE  
**Hamilton County**

Kenton C. Ward, Surveyor

773-6110 Ext. 19

Noblesville, Ind. 46060 February 1 1983

TO: Hamilton County Drainage Board

RE: Wilson & Nagle Drainage Area

Attached is an assessment roll, drain map and drainage shed map for the Wilson & Nagle Drainage Area. This drainage system consists of the Martz and Treitch, Wm Wilson, Wm Nagle and Guy Booth Drains. These drains are located in Sections 13, 14, 23 and 24, Township 20 North, Range 4 East in Jackson Township and within the Town of Arcadia.

The Wm Wilson Drain was originally the Isaac Martz & Peter Trietch. This drain was constructed in 1882 by order of the Circuit Court. It consisted of a main ditch 6700 feet in length and a arm 540 feet for a total of 7240 feet of open drain. In 1894 the Wm Wilson Drain was ordered constructed by the Commissioners. This consisted of placing tile in 5410 feet of the old Martz and Trietch Main Open Ditch.

The Wm Nagle Drain was originally constructed in 1882 by order of the Circuit Court. This drain was 4477 feet of main ditch, Arm #1 was 719 feet and Arm #2 was 391 feet for a total length of 5587 feet. In 1892 the Commissioners ordered constructed a second Wm Nagle Drain. This consisted of a main ditch 3000 feet which duplicated Arm #2 of the original Nagle and a part of the Martz & Treitch Drain. Arm #1 was a duplication and extension of the original Main Nagle Drain and was 3813 feet in length. Arm #2 was the same as the original Nagle Arm #2 and was 391 feet in length. This drain then consisted of 7204 feet.

In 1921 the Guy Booth Drain was ordered constructed by the Circuit Court. This drain extended, tiled and retiled the Wm Nagle and Wm Wilson Drains. This drain also rerouted a portion of the Nagle Drain. In doing so 600 feet of the 1892 Nagle Drain was rerouted from STA 13+00 to STA 19+00 of the

main ditch. The rerouting consisted of 965 feet and the extension was 1118 feet

for a total of 2083 feet of new, non duplicated drain.

For simplicity's sake when the Nagle Drain is discussed it shall be the 1892 drain. The Wilson shall be both the Martz & Trietch and Wilson. THE Booth shall be that portion which did not duplicate either the Wilson or Nagle

A fifth drain known as the Jacob Gettle was found not to exist. It was dismissed in Circuit Court in November 1891 and never constructed.

The last assessment and repair by the county on these drains was in 1951. However, the Town of Arcadia has done repair and some rerouting on its own. In 1966 the Town rerouted two portions of the drains without cutting off the old portion which are still in operation. This was done to relieve the under capacity of the old drain. One rerouting started at STA 20 of the Booth and ended at STA 34+10 of the Booth. This consisted of 1587 feet of new storm sewer. The other location started at STA 11+50 of the Wm Wilson to STA 0 of the Booth Drain. This consists of 1253 feet of new storm sewer. These storm sewer improvements are shown on plans by Stoeppelwerth & Assoc. dated August 29, 1966.

At present the drainage system consists of the following:

William Wilson Drain	7240 feet
William Nagle Drain	6304 feet
Guy Booth Drain	<u>2083 feet</u>
TOTAL	<u>15,627 feet</u>

Upon inspection the above named drains seem to be in good condition.

My recommendation to the Drainage Board is as follows:

1. Vacate Arm #1 of the Martz & Treitch Drain, 540 feet
2. Extend the Booth Drain from the Headwall at STA 34+10 to the East Right of Way line of State Road 19, 506 feet
3. Accept the storm sewer system installed by the Town of Arcadia as part of the Booth Drain as discussed above. Arm #2 would be an extension from STA 11+50 of the Wilson to STA 0 of the Booth and Arm #3 would be an extension from STA 20 to STA 34+10 of the Booth Drain. The existing tile from STA 30 of the Nagle to 34+10 of the Booth should remain a part of the drain system for overflow purposes. This would add 2840 feet to the Booth Drain.
4. Place the Wilson and Nagle Drainage area on a maintenance program. With 669.3046 acres and 557 Lots in the drainage shed at \$2.00 per acre, \$6.00 minimum assessment will generate \$5177.40 annually. This had been requested on March 28, 1968 by Wayne Noel-Town Trustee for the Nagle and on March 24, 1969 by the Town of Arcadia by Russell Whisler on both the Nagle and Wilson Drains.
5. A hearing for the above should be set for April 4, 1983 at 1:35pm

Upon completion of the above recommendations the total length of the drains will be increased to ~~18,433~~ feet.

*18,833 feet by adding Armit #1*

KCW/no

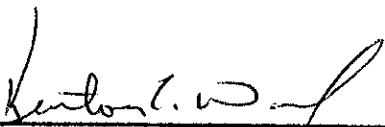
---

Kenton C. Ward-County Surveyor



**FILED**  
JAN 20 1933  
HAMILTON COUNTY DRAINAGE BOARD  
SECRETARY

PROJECT B - SANITARY SEWERS  
INDIANA  
ARCADIA

This information was gathered for input into the Hamilton County Geographical Information System. This document is considered an official record of the GIS.  
Entry Date: 9-9-04  
Entered by: jwj

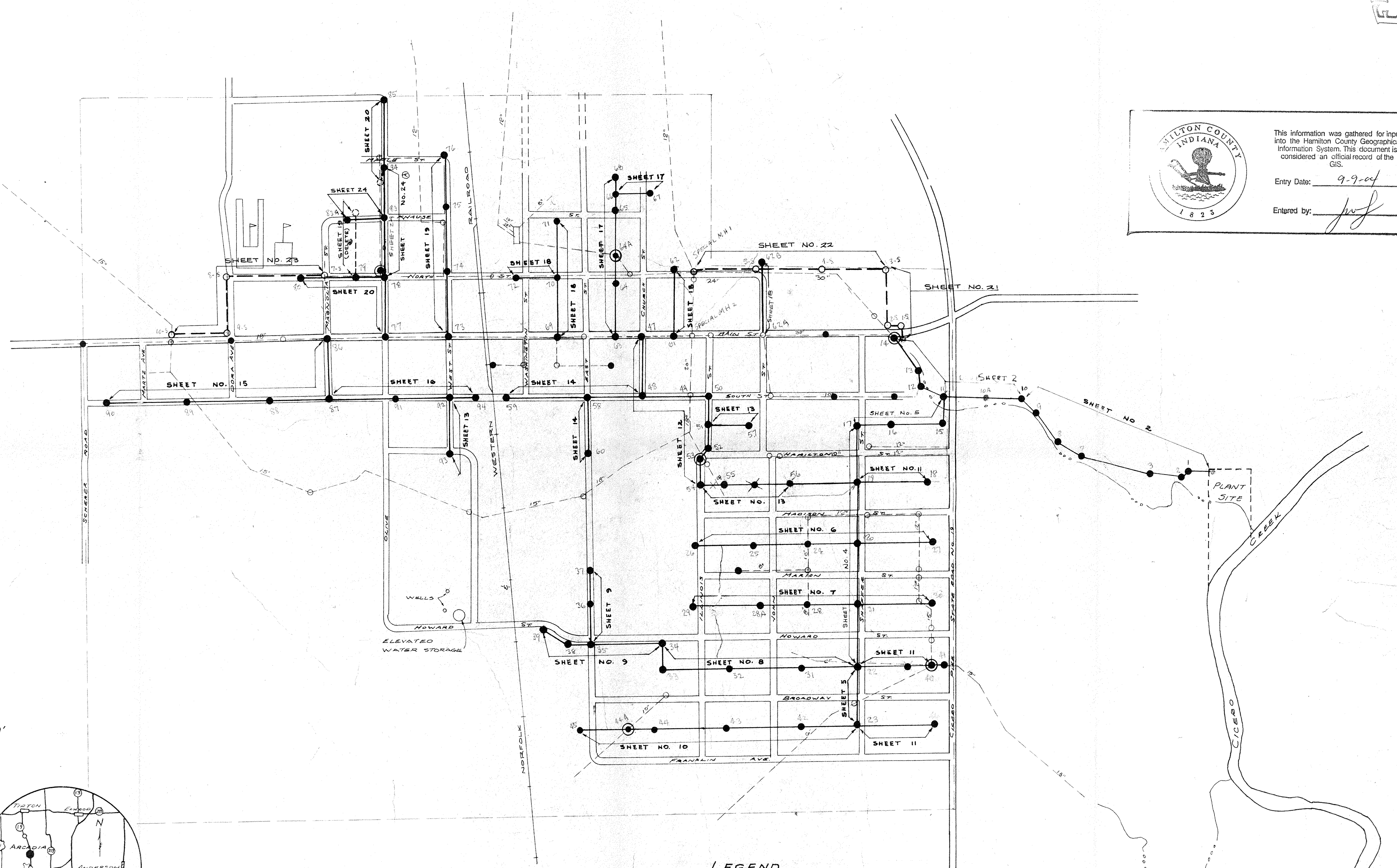

SCALE 1"=300'

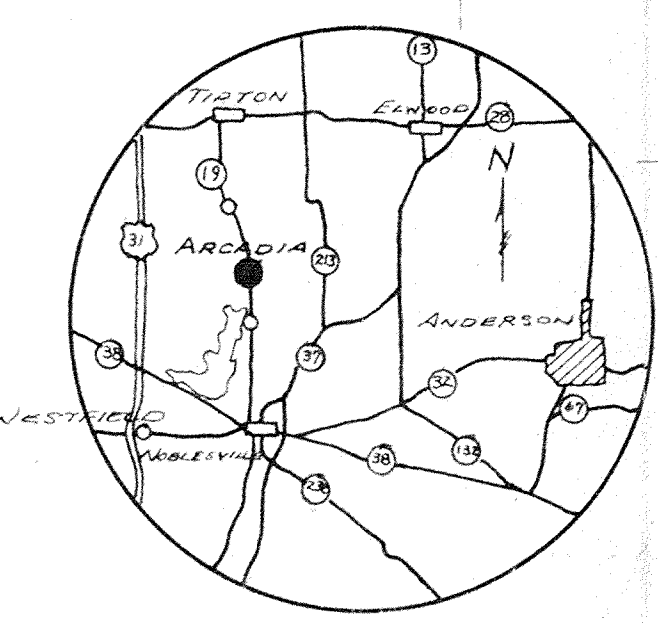

**LEGEND**

- EXISTING SEWER AND MANHOLE
- PROPOSED SANITARY SEWER
- SPECIAL INTERCEPTOR STRUCTURE
- CORPORATION LIMITS
- PROPOSED STORM SEWER
- ISOLATED MANHOLE (NEW MANHOLE OVER EXISTING SEWER)

STOEPPELWERTH & ASSOCIATES  
CIVIL ENGINEERS  
INDIANAPOLIS, INDIANA

JOB NO.	693
BY	R.T.F.
SCALE	1"=300'
DATE	8-20-06



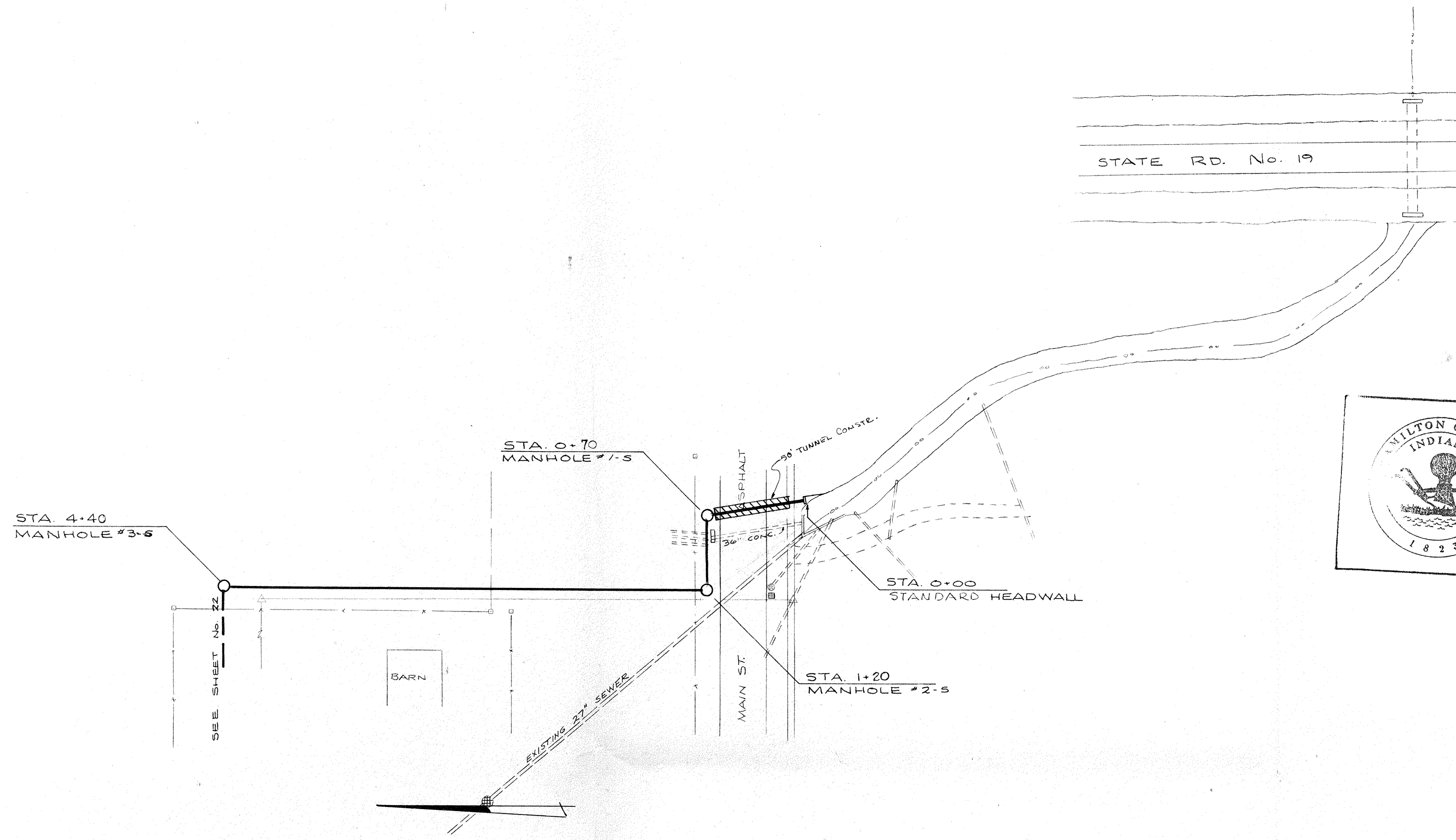

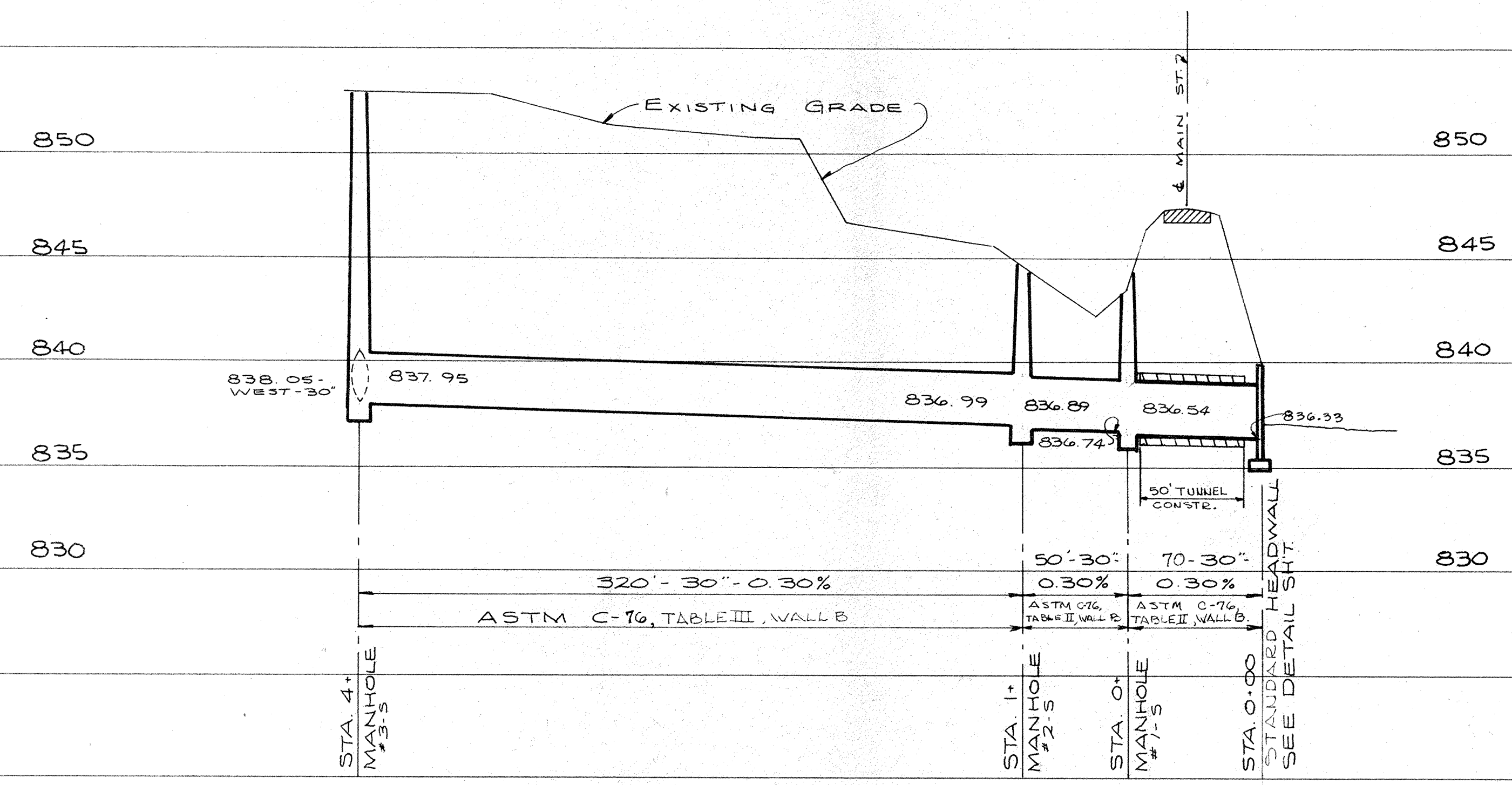

 This information was gathered for input into the Hamilton County Geographical Information System. This document is considered an official record of the GIS.  
 Entry Date: 9-9-01  
 Entered by: *[Signature]*



SHEET NO. 21		OF 23 SHEETS	
JOB NO. 694		BY	
DATE 8-29-06		MARK/DATE	
REVISIONS		BY	
<b>STOEPPELWERTH &amp; ASSOCIATES</b> CONSULTING ENGINEERS INDIANAPOLIS, INDIANA			
INDIANA		INDIANA	
STORM SEWER IMPROVEMENTS		INDIANA	
SHEET NO. 21		OF 23 SHEETS	
JOB NO. 694		BY	



This information was gathered for input into the Hamilton County Geographical Information System. This document is considered an official record of the GIS.

Entry Date: 9-9-04

Entered by: [Signature]

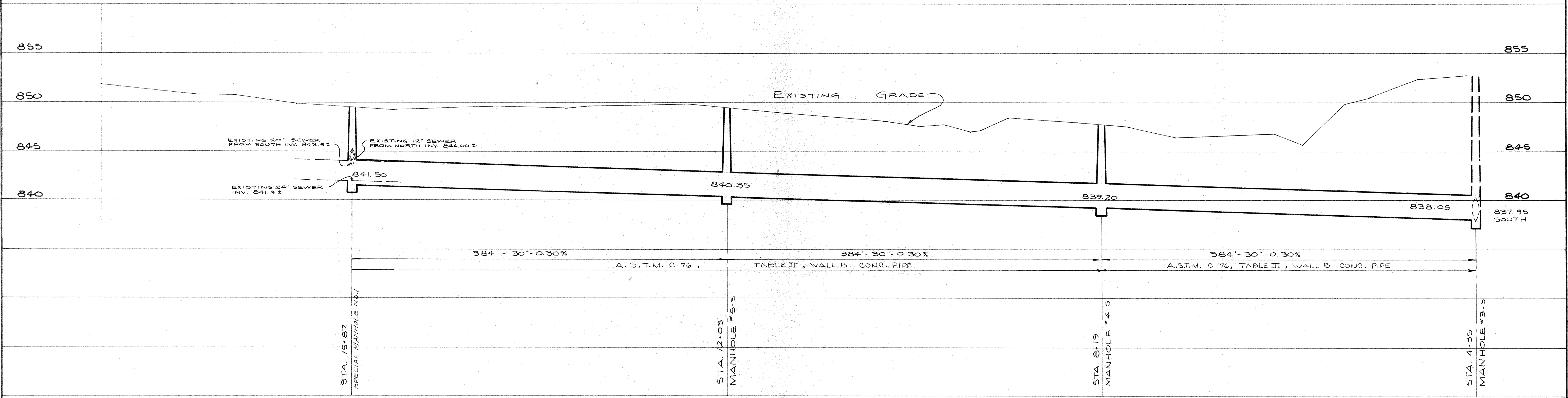
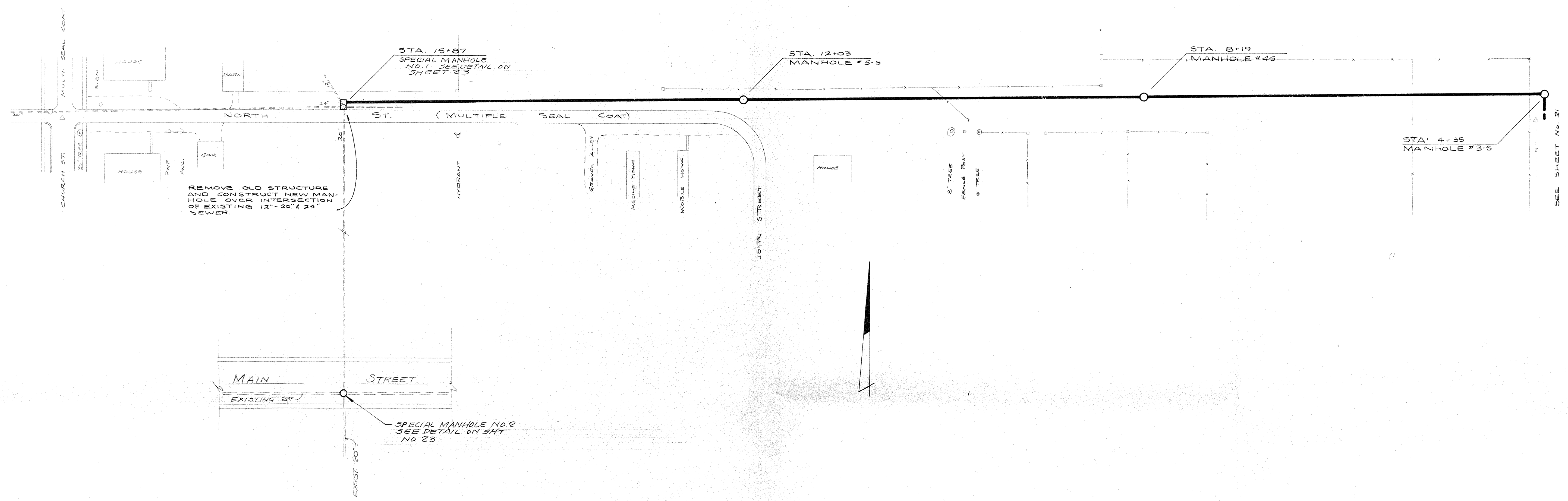

SHEET NO. **22**  
OF 23 SHEETS  
JOB NO. 694

**STOEPPELWERTH & ASSOCIATES**  
CONSULTING ENGINEERS  
INDIANAPOLIS, INDIANA

**STORM SEWER IMPROVEMENTS**  
INDIANA

ARCADIA

SHEET NO. **22**  
OF 23 SHEETS  
JOB NO. 694

NO.	DATE	BY	REVISIONS

DATE: 8-29-06  
MARK DATE:





This information was gathered for input into the Hamilton County Geographical Information System. This document is considered an official record of the GIS.

Entry Date: 9-9-04

Entered by: [Signature]

SHEET NO. 23  
 OF 23 SHEETS  
 JOB NO. 694

NO.	DATE	BY	REVISIONS
1	08-29-06		MARK DATE

STOEPPELWERTH & ASSOCIATES  
 CONSULTING ENGINEERS  
 INDIANAPOLIS, INDIANA

INDIANA

STORM SEWER IMPROVEMENTS

ARCADIA

SHEET NO. 23  
 OF 23 SHEETS  
 JOB NO. 694

